



A
BLOOMING
BRITISH

AFTERNOON TEA

CHELSEA FLOWER SHOW SPECIAL

A celebratory afternoon tea with the
Natural History Museum

*Supporting a future where people
and pollinators thrive*



Natural
History
Museum

ROYAL
LANCASTER
LONDON

Introduction

Welcome to A Blooming British Afternoon Tea in collaboration with the Natural History Museum; a floral-inspired twist on a quintessentially British tradition, in a celebration of the beautiful flowers and precious pollinators on our doorstep.

Taking inspiration from artworks held within the Museum's archives, their newly transformed gardens that provide a haven for people and wildlife, and the idyllic 30-minute nature walk across leafy Hyde Park that brings us together, our talented pastry team have created a thoughtful menu that beautifully honours the elegance of British flora and fauna, using locally-sourced, seasonal ingredients.

This special collaboration combines the Museum's expertise and work to protect the natural world, with our ongoing sustainability efforts, and a shared passion for pollinators, a commitment Royal Lancaster London continues to uphold to this day.

Together, we support a future where people and pollinators thrive.



Prices

£49 Monday to Friday

£55 Saturday and Sunday

£30 Children's Afternoon Tea

Make it extra special...

£15 *Nyetimber Classic Cuvee MV*

£18 *Nyetimber Rosé MV*

£17 *Taittinger Brut Reserve NV, France*

£20 *Taittinger Brut Prestige Rose NV, France*

£9.50 *Noughty Sparkling Chardonnay non-alcoholic sparkling wine*

£9.50 *Noughty Sparkling Rose non-alcoholic sparkling wine*



Bespoke Teas

from Camellia's Tea House

The Royal Lancaster Afternoon Blend

A bespoke blend created to complement the savoury selection of our celebratory afternoon tea. An unusual combination of timeless English Breakfast, warm woody China Keemun with the floral notes of calming chamomile. This is a tea to relax with and savour time well spent with friends and loved ones.

The Pollinator Blend

Created exclusively for Royal Lancaster London, in partnership with the Natural History Museum, the Pollinator blend marries black teas from Darjeeling and China with cornflower, rose and marigold petals and the final flourish of organic bee pollen. Full of health-giving properties, the bee pollen adds a sweet honeyed note to this delightful celebration of the insects which keep Mother Nature in timeless bounty.



*Scan the QR code
to view allergen
information*

A Blooming British Afternoon Tea

SAVOURY

A selection of traditional sandwiches

Roast maize fed chicken with bee pollen and tarragon mayonnaise
on white bread

Maldon cured smoke salmon, cream cheese and dill on
wholemeal bread

Heritage tomato and buffalo mozzarella with basil pesto on white bread

Egg mayonnaise, flowering chives on wholemeal bread

Cucumber with salted butter on white bread



SCONES

Warm homemade scones served with clotted cream
and a selection of preserves



SWEET

A selection of pollinator-themed sweet bites

Strawberry Tart

Crème fraiche whip, Elderflower and strawberry compote, Sable Breton

The Beehive

Lemon thyme poached peach soft centre, white chocolate mousse,
olive oil sponge

Cherry Noir

Black cherry and kirsch confit, Chocolate financier, Black cherry mousse

Berrioleet

Violet infused raspberry and blueberry Crèmeux, vanilla sable, Lemon Chantilly

A discretionary 12.5% service charge will be added to your bill.

A Blooming British Vegan Afternoon Tea

SAVOURY

A selection of traditional sandwiches

Cucumber with vegan mayonnaise on white bread

Mixed grilled vegetable, basil pesto on wholemeal bread

Heritage tomato and vegan cream cheese with balsamic butter
on white bread

Beetroot hummus and red cabbage slow on wholemeal bread



SCONES

Warm homemade scones served with coconut cream
and a selection of preserves



SWEET

A selection of pollinator-themed sweet bites

Strawberry & Cream

Vanilla shortbread, elderflower and strawberry compote, meringue
“popcorn”, Chantilly cream

The Beehive

Lemon thyme poached peach soft centre, yogurt mousse,
maple sponge

Cherry Indulgence

Sacher sponge, cherry confit, cream cheese frosting

Berriolet

Violet infused raspberry and blueberry cremeux, vanilla sable,
lemon Chantilly cream

A discretionary 12.5% service charge will be added to your bill.

A Blooming British Children's Afternoon Tea

SAVOURY

A selection of miniature sandwiches

Chicken with mayonnaise on white bread

Cucumber and cream cheese sandwich on wholemeal bread

Egg sandwich on white bread



SCONES

Warm homemade scones served with clotted cream
and a selection of preserves



SWEET

A selection of pollinator-themed sweet bites

The Ladybird

Light vanilla mousse, caramelised apple, sablé Breton

Chocolate Seedball

Milk chocolate mousse, chocolate sponge

Butterflies & Berries

Vanilla cheesecake, mixed red berry compôte

Did you know...?

While honeybees get a lot of the credit, at least 1,500 insect species pollinate plants in the UK. In some parts of the world, birds, bats and even lizards get involved too!

Beetles are attracted to flat, open flowers which allow them to graze, and flowers in clusters, such as cow parsley. The flowers tend to be smelly or fragrant, because beetles navigate by a strong sense of smell.

Cereals, such as wheat and barley, rely on wind pollination but just about every other plant we eat is actively pollinated. Tomato production relies on pollination by bumblebees, as do many other crops.

Adult butterflies and moths will feed on almost any flower's nectar, but caterpillars are fussier, so try planting a variety of flowers to encourage more insects to visit your garden.

Things you can do to help:

1. Grow pollinator-friendly plants in your garden or on your windowsill
2. Let your lawn grow a little wilder
3. Build a home for solitary bees

Scan the QR code for 'How To' videos, and a digital version of our Nature Walk map.



For an animal to be an effective pollinator it needs to actively visit flowers of the same species and be capable of carrying pollen on its body (often unintentionally) so that it transfers from one flower to another.

There are just 57 resident butterfly species in the UK, compared to more than 2,500 moth species.

The list of insect pollinators is long and includes many different species of bees, flies, wasps, beetles, butterflies and moths. Pollinators carry pollen with them as they move from flower to flower.

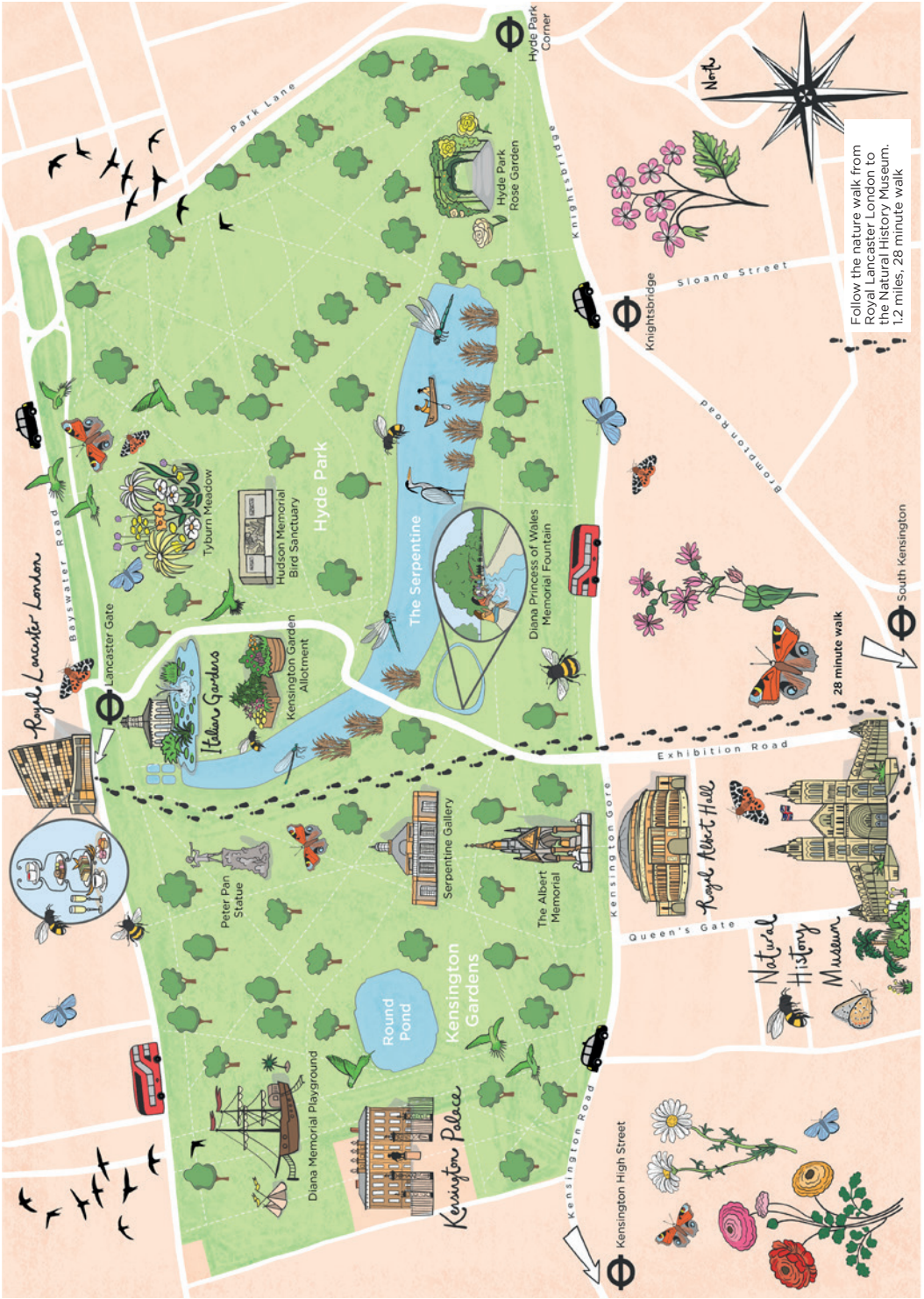

Royal Lancaster London

Park Lane

Hyde Park Corner

North

Follow the nature walk from Royal Lancaster London to the Natural History Museum. 1.2 miles, 28 minute walk

Knightsbridge

Sloane Street

Knightsbridge

South Kensington

28 minute walk

Exhibition Road

Kensington Gate

Royal Albert Hall

Natural History Museum

Queen's Gate

Kensington High Street

Kensington Palace

Kensington Gardens

Serpentine Gallery

The Albert Memorial

The Serpentine

Hyde Park

Hudson Memorial Bird Sanctuary

Tyburn Meadow

Lancaster Gate

Italian Gardens

Kensington Garden Allotment

Peter Pan Statue

Round Pond

Diana Memorial Playground

